

# COATESVILLE

229m<sup>2</sup>
 2
 2
 4
 2

The Coatesville plan features two stunning pavilions - one exclusively designed for the main living area, while the other caters to four spacious bedrooms and a versatile study or home office. With a covered alfresco space, a chef's dream kitchen, and a dual-sided gas fire, this architecturally designed home is bound to leave you in awe.



## HOME FEATURES

- Four double bedrooms
- Ensuite and walk-in wardrobe in master
- Open plan family and dining
- Galley style kitchen with scullery
- Separate living room
- Study or home office
- Alfresco dining
- Fixed price contract
- 10 year residential build guarantee

## HOME DIMENSIONS

**Length:** 15.08m

**Width:** 23.95m

**Area over cladding:** 229.43m<sup>2</sup>

**Area over framing:** 229.43m<sup>2</sup>

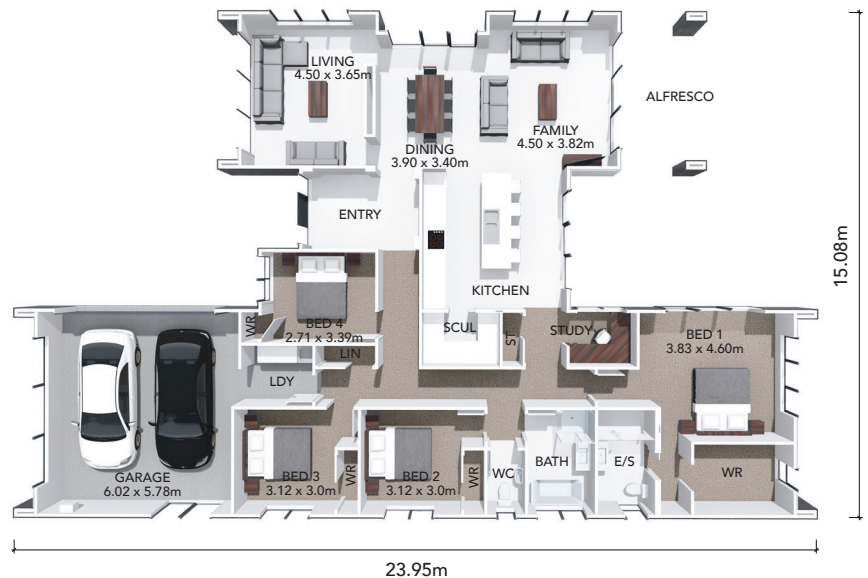

*The overall size of the home (m2) is indicative only as the exterior cladding detail selected may alter the final dimensions.*