

MOTITI

180m²
 2
 2
 3
 2

Introducing the Motiti, a stunning two-level home that beautifully embraces the concept of open plan design while providing the ideal balance of privacy and space. With its contemporary features, including a separate living area and a cosy study nook on the upper level, this home offers something for everyone. The Motiti is perfectly tailored to accommodate growing families, inter-generational living, or even changing work environments.



HOME FEATURES

- Three double bedrooms
- Ensuite and walk-in wardrobe in master bedroom
- Open plan kitchen, dining & family area
- Galley kitchen with appliances
- Separate living area
- Study nook
- Double garage with internal access and laundry
- Fixed price contract
- 10 year residential build guarantee

HOME DIMENSIONS

Length: 18.88m

Width: 8.14m

Area over cladding: 123.37m²

Area over framing: 120.86m²

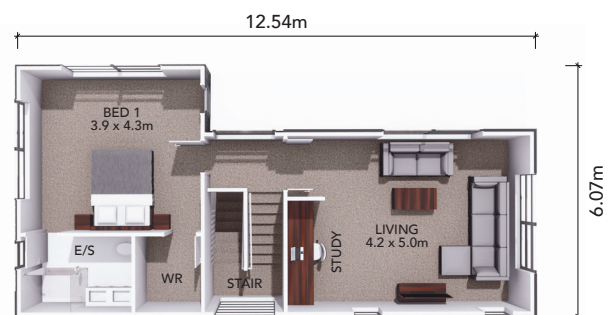
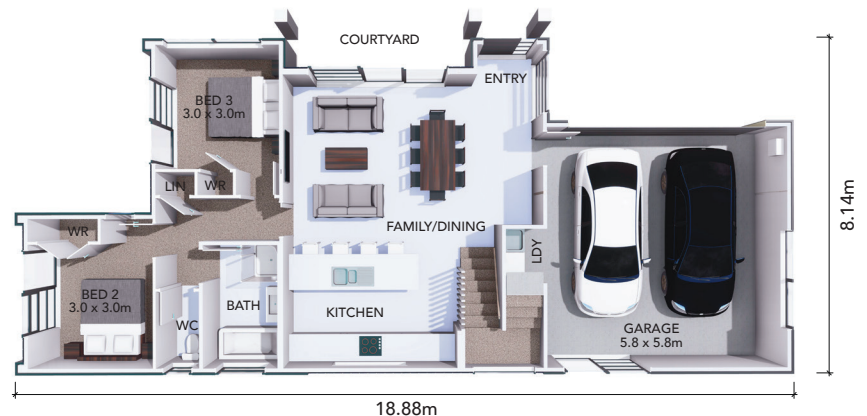

The overall size of the home (m²) is indicative only as the exterior cladding detail selected may alter the final dimensions.