

MURIWAI

292m²
 1
 2
 4
 2

The Muriwai plan offers a spacious four-bedroom layout, with a stunning open kitchen, dining, and family area right at the heart of the home. Designed to maximise the seamless transition between indoor and outdoor living, it features an extensive alfresco area. Additionally, the home boasts a spacious home office, along with a luxurious ensuite and walk-in wardrobe in the master bedroom.



HOME FEATURES

- Four double bedrooms
- Master bedroom with ensuite and walk-in wardrobe
- Open-plan kitchen, family and dining
- Large office
- Galley kitchen with scullery
- Double garage with internal access
- Full laundry with exterior access
- Fixed price contract
- 10 year residential build guarantee

HOME DIMENSIONS

Length: 25.06m

Width: 21.40m

Area over cladding: 292.19m²

Area over framing: 292.19m²

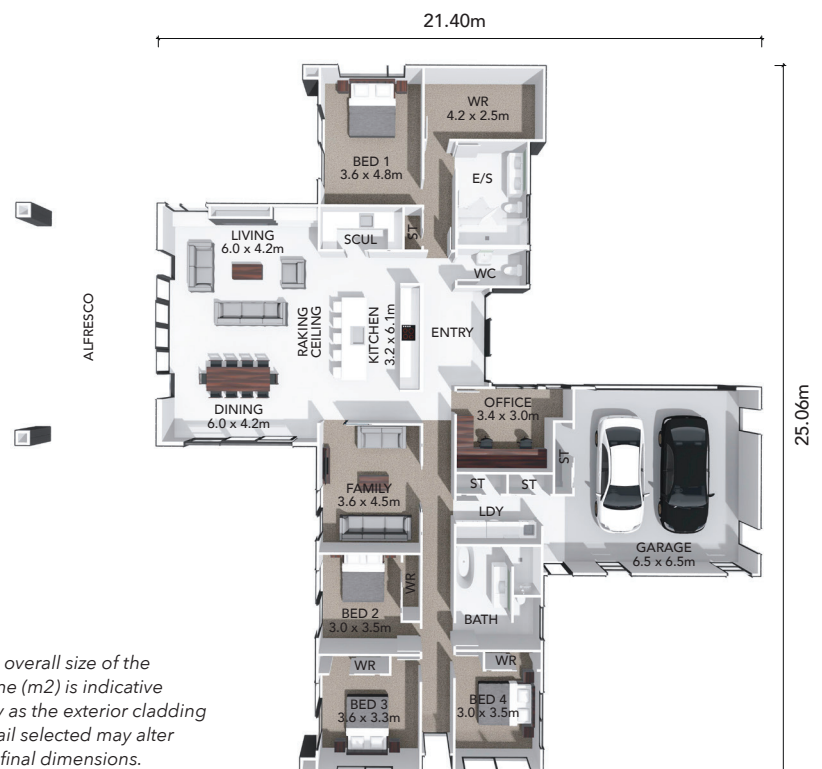

The overall size of the home (m²) is indicative only as the exterior cladding detail selected may alter the final dimensions.